

Legend

-  Delineator
-  Sign Stand
-  traffic controller
-  Work Area

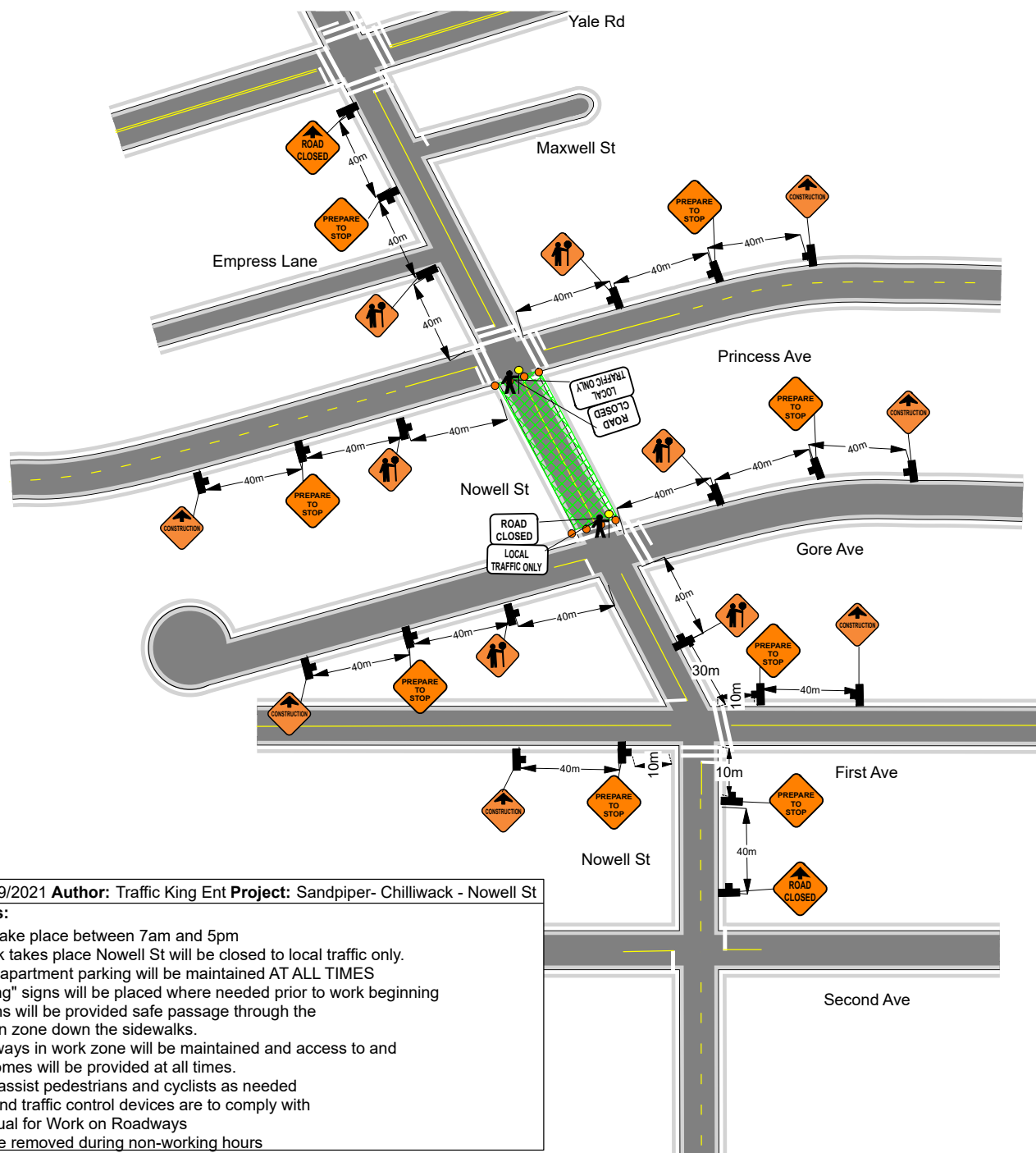







Date: 04/29/2021 **Author:** Traffic King Ent **Project:** Sandpiper- Chilliwack - Nowell St

Comments:

- Work will take place between 7am and 5pm
- While work takes place Nowell St will be closed to local traffic only.
- Access to apartment parking will be maintained AT ALL TIMES
- "No Parking" signs will be placed where needed prior to work beginning
- Pedestrians will be provided safe passage through the construction zone down the sidewalks.
- Any driveways in work zone will be maintained and access to and from the homes will be provided at all times.
- TCPs will assist pedestrians and cyclists as needed
- All signs and traffic control devices are to comply with MOTI Manual for Work on Roadways
- Signs to be removed during non-working hours



SIGN CODES

- | | |
|--|--|
|  C-018-1A |  C-030-6A |
|  C-001-1 |  R-012 |
|  C-29 |  R-12T |